

• GREEN SLEEVES •

Adjustable Tree Staking Systems

Staking and Bracing Materials: Green Sleeves™ Tree Staking System

Green Sleeves™ Thin Line (TL) Tie Sleeves

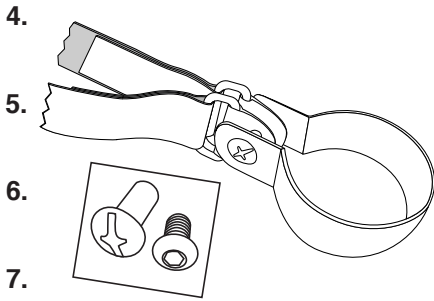

4. Model TL100™ plus Flex Tie

(shown on left)

NOTE: used with 1 1/2" OD Schedule 40 galvanized or aluminum pipe, or true 2" OD x 12' wood stake

5. Model TL150™ plus Flex Tie

(shown on left)

NOTE: used with 2 1/4" OD x 10' wood stake (lodgepole)

6. Model TL300™ plus Flex Tie

(shown on left)

NOTE: used with 3" OD x 10' wood stake (lodgepole)

7. Allen Bolt screw assembly (shown on left)

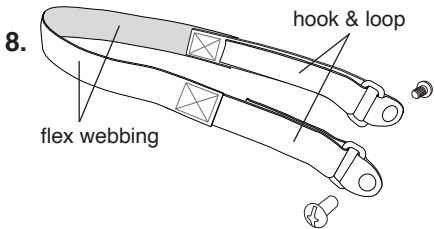

8. Green Sleeves™ Flex Tie:

(shown on left) Made up of 1" elastic webbing plus 1" elastic band with hook and loop velcro closure for easy adjustment. The length of tie is based on size of tree.

Green Sleeves™ Cross Braces



A. Two Stake System Cross Brace* with self-tapping screw

for 24" Box Tree use 24" cross-brace, for 36" Box Tree use 36" cross-brace (shown on left)

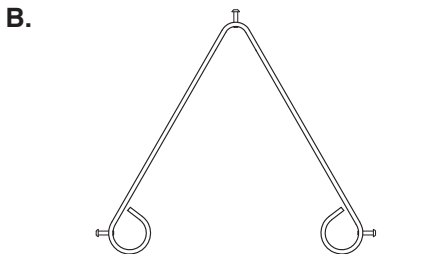

B. Three Stake System Cross Brace* with self-tapping screw

(for 24" or 36" Box Tree) (shown on left)

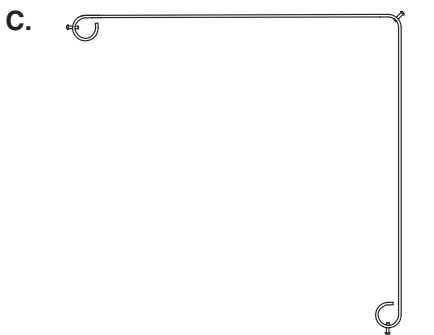

C. Four Stake System Cross Brace* with self-tapping screw—Use two braces for each tree (for 24", 36" or 48" Box Tree) (shown on left)

*Made of 1/4" x 1" aluminum flat bar.

Each of the three Cross Braces can be ordered with the three Sleeve sizes as per below.

Stakes are available in three sizes:

Model 100: 2 1/4" ID fits 1 1/4" ID Schedule 40 galvanized or aluminum pipe, or 2" lodgepole (actual 2" OD)

Model 150: 2 1/2" ID fits 2" lodgepole (actual 2" OD)

Model 300: 2.98" ID fits 3" lodgepole (actual 2.98" OD)

All Green Sleeves™ components, except stainless steel Allen Bolts, are powder coated in green or black.

All aluminum materials are manufactured in the USA. Material certifications are available upon request.

Sold by **Green Sleeves™** 7678 Sonoma Hwy 12, Santa Rosa, CA 95409-6611
 (415) 490-6744 Voice www.greensleeves.com